

1.4404  
Stainless Steel  
316L  
Seawater Resistant

### Griffserie ER

**Werkstoff und Oberfläche:**  
Griff aus Edelstahl, Werkstoff 1.4404 mit polierter Oberfläche.

**Tragkraft:**  
min. 1.000 N.

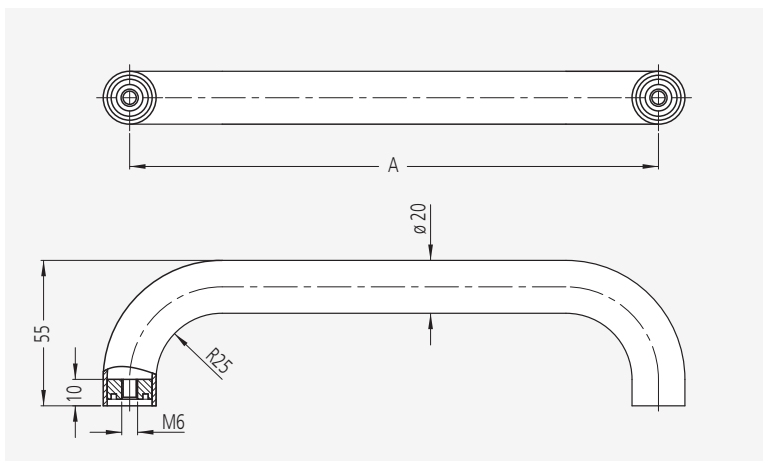

A	Bestell-Nr. Order no.
200	ER-20.B200.49
300	ER-20.B300.49

### Zubehör für Frontmontage Accessories for front mounting

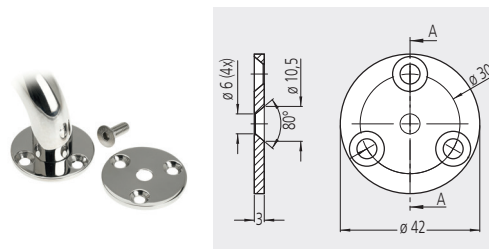

	Bestell-Nr. Order no.
1 Stück / 1 Piece	ER-20.B001.49

### Handle Series ER

**Material and surface:**  
Handle made of stainless steel, material 1.4404 (316L) with polished surface.

**Stress resistance:**  
min. 1.000 N.



© "chawa06"/Fotolia.com

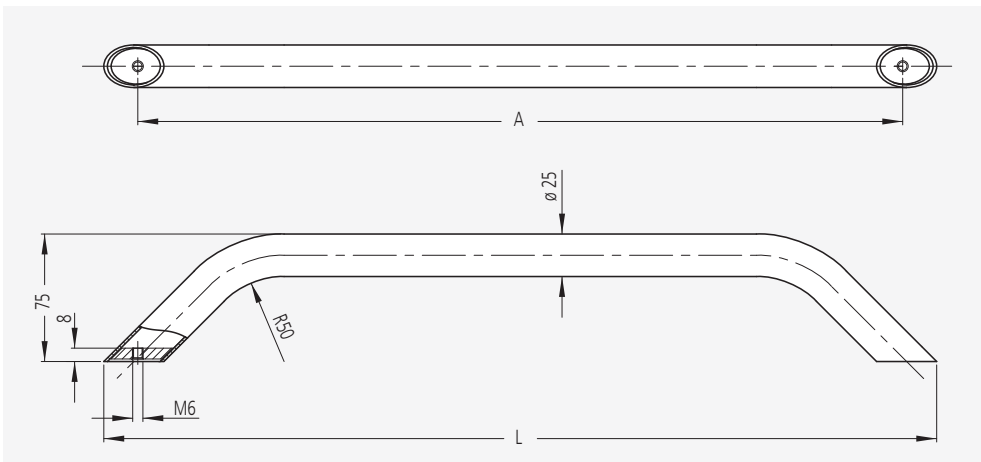

A	L	Bestell-Nr. Order no.
300	340	ER-25.A300.49
450	490	ER-25.A450.49
600	640	ER-25.A600.49
750	790	ER-25.A750.49
900	940	ER-25.A900.49

#### Zubehör für Frontmontage Accessories for front mounting

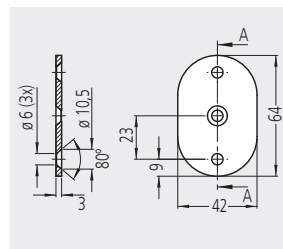

Bestell-Nr.  
Order no.

1 Stück / 1 Piece

ER-25.A002.49

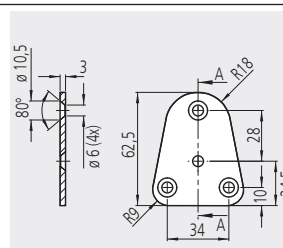

Bestell-Nr.  
Order no.

1 Stück / 1 Piece

ER-25.A001.49

Alle Maße in mm. / All dimensions in mm.